

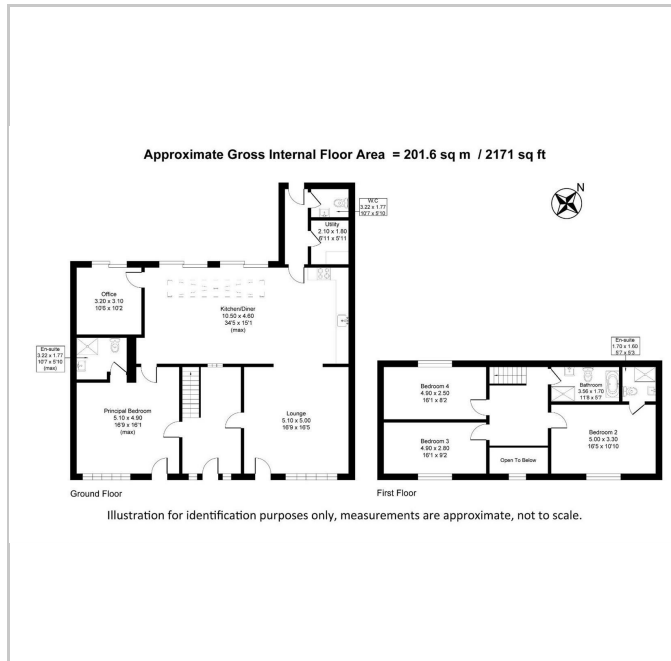

1 Wybersley Hall Barn, 1 Wybersley Place, High Lane, Stockport, SK6 8BA

£3,500 Per month

- Four Double Bedroomed End-Mews
- Open-Plan Ground Floor
- Separate Office Room/ Fifth Bedroom
- Three Double Bedrooms to First Floor
- Lawned Rear Garden
- Bespoke Luxury Kitchen with Appliances
- Separate Utility Room
- Ground Floor Principle Bedroom with Wet Room
- Allocated Off-Road Parking
- Available Immediately



Directions

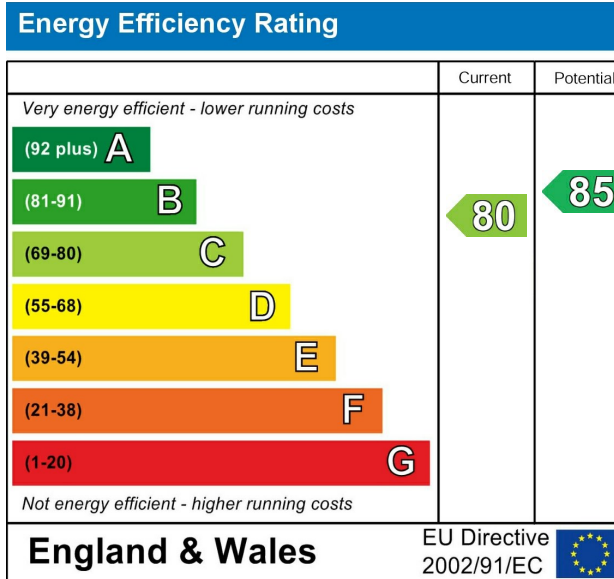

THE PROPERTY

This Fabulous FOUR DOUBLE BEDROOMED End-Mews Property is situated in a Brand New Barn Conversion Development, neighbouring a working farm and nestled in the Countryside, on the border of Disley and High Lane.

In brief, the accommodation comprises: Entrance from the rear into a Hallway with Downstairs WC and Separate Utility Room to the front. Beyond is a Bespoke and Luxury Fitted Kitchen, complete with Kitchen Island and Integral Appliances. The ground floor is largely Open-Plan, with a Large Dining/ Living Area to the front with Beautiful Floor to Ceiling windows allowing in Ample Light and offering stunning views of the Manchester Sky Line on a clear day. To the rear is another Living/ Dining Area. At the end is a Separate Office Room/ Fifth Bedroom, with Patio Doors leading out to the rear Garden. The Principal Bedroom boasts disabled access and an Ensuite Wet Room. Stairs lead from the Front Hallway to the First Floor Landing, where there are Three Double Bedrooms, with Bedroom Two boasting an Ensuite Shower Room, and a Modern Family Bathroom.

Externally, there property boasts allocated Off-Road Parking with EV Charging, and a Lawned Garden to the rear. The property is offered on an Unfurnished Basis and EPC Grade- C. Council Tax to Follow. Available Immediately.